

# Installation Manual

for "Face Mount/ PVC/Sliding/Single"

"Face Mount/PVC/Roll up/Catching Frame"

## 1. Assemble

\* Refer to the Drawing of a completed installation as well.

\* The side with the double-sided tape is a sash frame side.

1) As shown in the drawing right above, make sure the projection of the Sliding Bar runs in the center groove in the Rail, and insert the Joint of the main Component into the rail.

2) Same as 1), insert the Joint on the Catching Frame side into the Rail, and frame all sides.

(!) Insert to back fixedly.

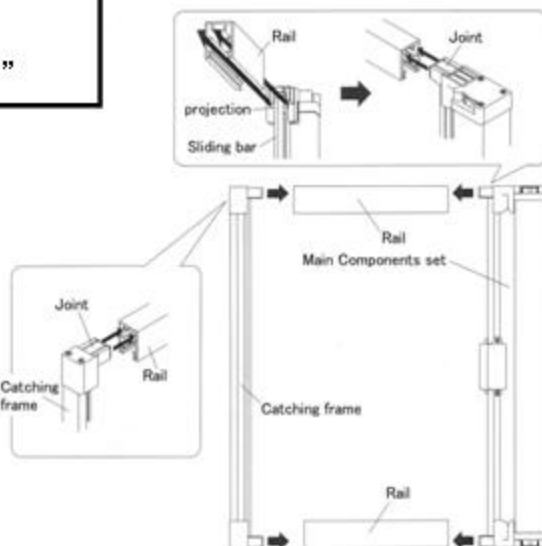

## 2. Install the Screen

\* Do not remove the backing of the double-sided tape and the Binding Tape at this point.

■ Install to the sash frame

1) Refer to the Drawing of a completed installation, put the screen assembled in Step 1 to the window before installing, and confirm the installing position.

2) Remove the backing of the double-sided tape and the Binding Tape, and mount the screen on the position which confirmed in 1).

(!) Before affixing, clean dirt off the sash frame, and affix firmly.

• Do not install as like these drawing.



• They make some problems on the operation.

### ■ Changing the Housing side

Change the Housing side by changing the up and down of the screen adapting to the sash mounting side.

When the screen type is the Roll Up, make the Housing position above.

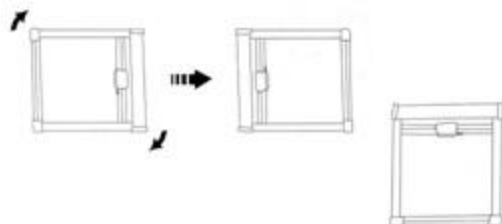

### ● Adjust the Lock Adjustment

The Lock Adjustment keeps the Mesh from coming out more than necessary.

Set the right screen and the left screen at the center of the opening, and dial to the direction of the 'FIX' arrow until dial stops.

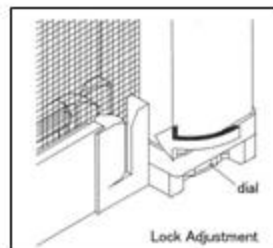

### ● Adjust the Spring Adjustment

The Spring Adjustment adjusts the winding power of the screen.

Open and close the screen. When the winding power is weak, turn the dial to the 'Strong' arrow. When the window power is strong, turn the dial to the 'Weak' way.

